

订货信息：16501140-(连接器 I 代码)-(连接器 II 代码)-(长度)

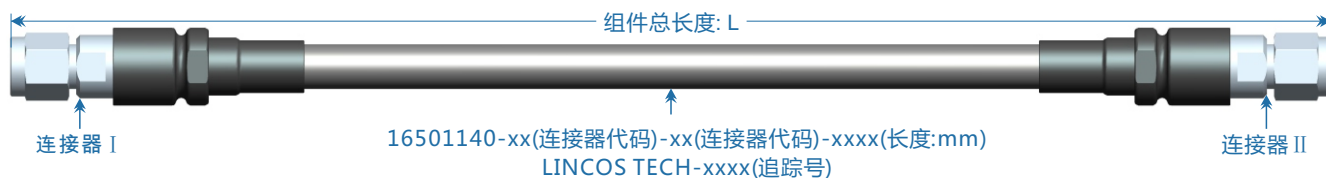

可选连接器

2.92-J (代码 01)

应用频率: 40 GHz

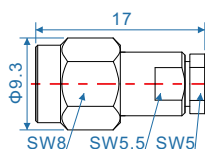

2.92-K (代码 02)

应用频率: 40 GHz

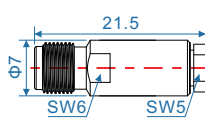

3.5-J (代码 03)

应用频率: 26.5 GHz

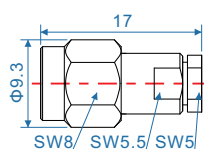

3.5-K (代码 04)

应用频率: 26.5 GHz

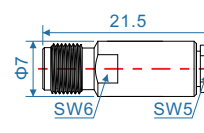

SMA-J (代码 05)

应用频率: 18 GHz

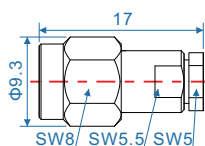

SMA-K (代码 06)

应用频率: 18 GHz

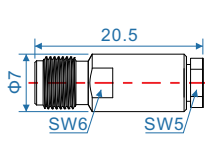

N-J (代码 07)

应用频率: 18 GHz

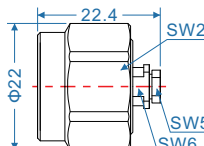

N-K (代码 08)

应用频率: 18 GHz

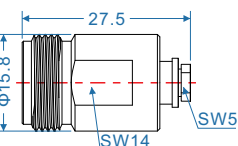

SMP-J (代码 09)

应用频率: 26.5 GHz

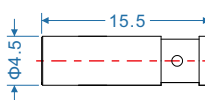

SMP-K (代码 10)

应用频率: 26.5 GHz

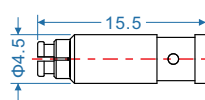

2.4-J (代码 17)

应用频率: 50 GHz

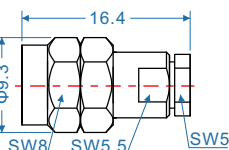

2.4-K (代码 18)

应用频率: 50 GHz

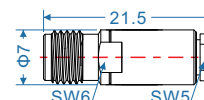

SMMP-J (代码 31)

应用频率: 40 GHz

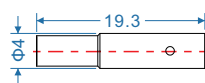

SMMP-K (代码 32)

应用频率: 40 GHz

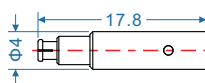

SMA-JW (代码 33)

应用频率: 18 GHz

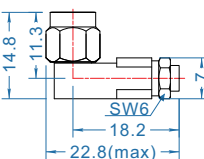

Order information: 16501140-(Connector I code)-(Connector II code)-(L)

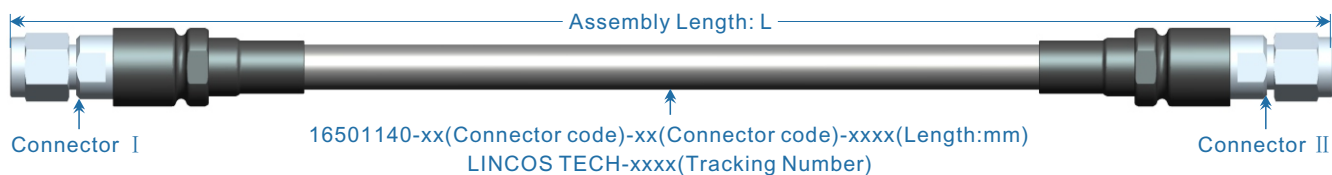

Available connectors

2.92-J (Code 01)

Max Operating Freq: 40 GHz

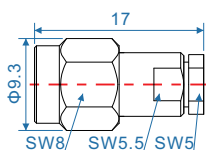

2.92-K (Code 02)

Max Operating Freq: 40 GHz

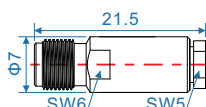

3.5-J (Code 03)

Max Operating Freq: 26.5 GHz

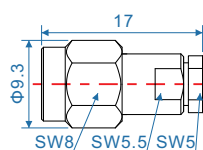

3.5-K (Code 04)

Max Operating Freq: 26.5 GHz

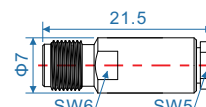

SMA-J (Code 05)

Max Operating Freq: 18 GHz

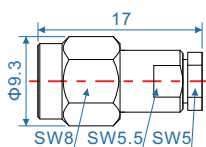

SMA-K (Code 06)

Max Operating Freq: 18 GHz

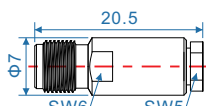

N-J (Code 07)

Max Operating Freq: 18 GHz

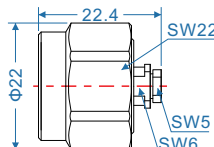

N-K (Code 08)

Max Operating Freq: 18 GHz

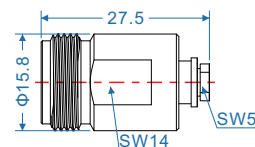

SMP-J (Code 09)

Max Operating Freq: 26.5 GHz

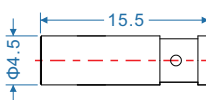

SMP-K (Code 10)

Max Operating Freq: 26.5 GHz

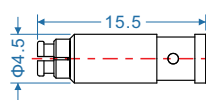

2.4-J (Code 17)

Max Operating Freq: 50 GHz

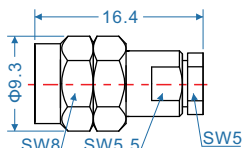

2.4-K (Code 18)

Max Operating Freq: 50 GHz

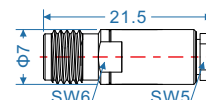

SMJM-J (Code 31)

Max Operating Freq: 40 GHz

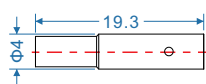

SMJM-K (Code 32)

Max Operating Freq: 40 GHz

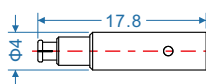

SMA-JW (Code 33)

Max Operating Freq: 18 GHz

